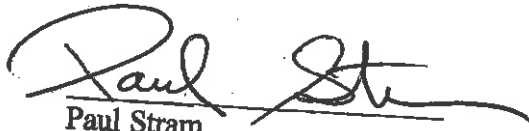

CERTIFICATION OF BUSINESS RECORDS PURSUANT TO N.Y. C.P.L.R. 3122-a

1. The affiant is the duly authorized custodian or other qualified witness and has authority to make the certification;
2. To the best of the affiant's knowledge, after reasonable inquiry, the records or copies thereof are accurate versions of the documents described in the subpoena duces tecum that are in the possession, custody, or control of the person receiving the subpoena;
3. To the best of the affiant's knowledge, after reasonable inquiry, the records or copies produced represent all the documents described in the subpoena duces tecum, or if they do not represent a complete set of the documents subpoenaed, an explanation of which documents are missing and a reason for their absence is provided; and
4. The records or copies produced were made by the personnel or staff of the business, or persons acting under their control, in the regular course of business, at the time of the act, transaction, occurrence or event recorded therein, or within a reasonable time thereafter, and that it was the regular course of business to make such records.

  
Paul Stram

STATE OF NEW YORK

COUNTY OF SUFFOLK <sup>February</sup>

On the 10<sup>th</sup> day of ~~January~~ <sup>February</sup> in the year 2016 before me, the undersigned, personally appeared Paul Stram, personally known to me or proved to me on the basis of satisfactory evidence to be the individual(s) whose name(s) is (are) subscribed to the within instrument and acknowledged to me that he/she/they executed the same in his/her/their capacity (ies), and that by his/her/their signature(s) on the instrument, the individual(s), or the person upon behalf of which the individual(s) acted, executed the instrument.

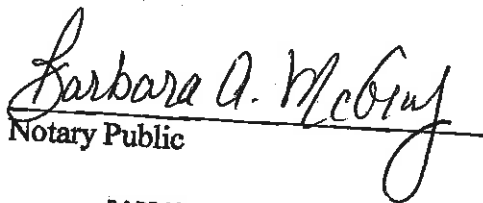
  
Notary Public

BARBARA A. MCGIVNEY  
NOTARY PUBLIC-STATE OF NEW YORK  
No. 01MC6328934  
Qualified In Suffolk County  
My Commission Expires August 10, 2019



ITEM NO.	DESCRIPTION	QTY.	UNIT
1	CONCRETE DRIVEWAY		
2	CONCRETE CURB		
3	CONCRETE SIDE WALK		
4	CONCRETE PAVEMENT		

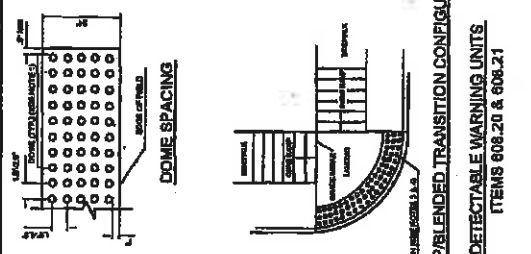
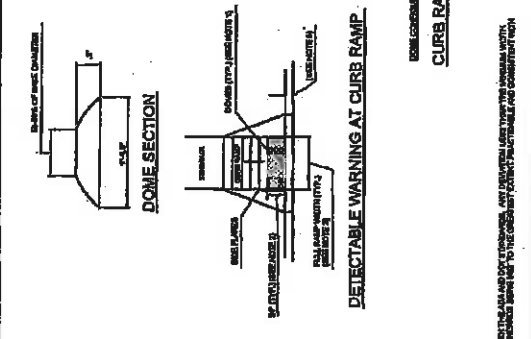
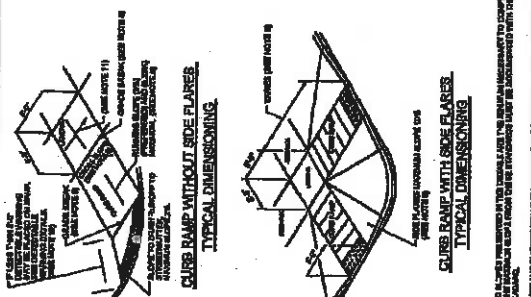
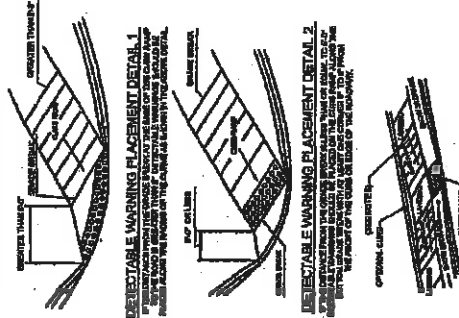

- GENERAL NOTES:**
1. THE DETECTABLE WARNING UNITS SHALL BE CONFORMANT WITH THE REQUIREMENTS OF THE INTERNATIONAL BUILDING CODE (IBC) AND THE DETECTABLE WARNING ACT (DWA) AS AMENDED BY THE DEPARTMENT OF TRANSPORTATION AND FEDERAL HIGHWAY ADMINISTRATION.
  2. THE DETECTABLE WARNING UNITS SHALL BE INSTALLED IN ACCORDANCE WITH THE DETECTABLE WARNING ACT (DWA) AS AMENDED BY THE DEPARTMENT OF TRANSPORTATION AND FEDERAL HIGHWAY ADMINISTRATION.
  3. THE DETECTABLE WARNING UNITS SHALL BE INSTALLED IN ACCORDANCE WITH THE DETECTABLE WARNING ACT (DWA) AS AMENDED BY THE DEPARTMENT OF TRANSPORTATION AND FEDERAL HIGHWAY ADMINISTRATION.
  4. THE DETECTABLE WARNING UNITS SHALL BE INSTALLED IN ACCORDANCE WITH THE DETECTABLE WARNING ACT (DWA) AS AMENDED BY THE DEPARTMENT OF TRANSPORTATION AND FEDERAL HIGHWAY ADMINISTRATION.
  5. THE DETECTABLE WARNING UNITS SHALL BE INSTALLED IN ACCORDANCE WITH THE DETECTABLE WARNING ACT (DWA) AS AMENDED BY THE DEPARTMENT OF TRANSPORTATION AND FEDERAL HIGHWAY ADMINISTRATION.
  6. THE DETECTABLE WARNING UNITS SHALL BE INSTALLED IN ACCORDANCE WITH THE DETECTABLE WARNING ACT (DWA) AS AMENDED BY THE DEPARTMENT OF TRANSPORTATION AND FEDERAL HIGHWAY ADMINISTRATION.

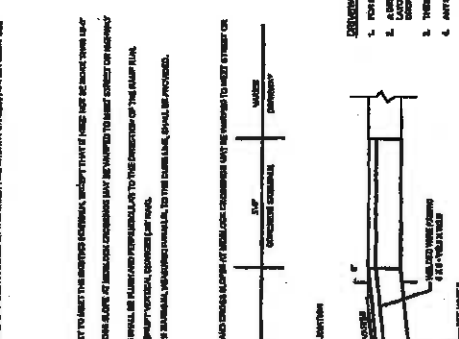
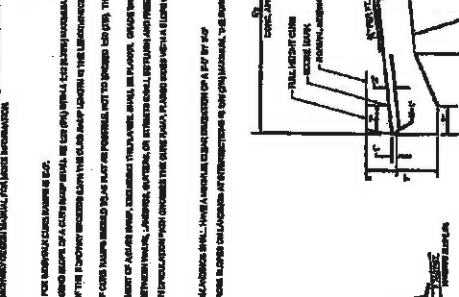

- DRIVEWAY ENTRANCE NOTE:**
1. FOR RAMP DRIVEWAY ENTRANCES, THE DRIVEWAY SHALL BE CONFORMANT WITH THE REQUIREMENTS OF THE DETECTABLE WARNING ACT (DWA) AS AMENDED BY THE DEPARTMENT OF TRANSPORTATION AND FEDERAL HIGHWAY ADMINISTRATION.
  2. THE DRIVEWAY SHALL BE CONFORMANT WITH THE REQUIREMENTS OF THE DETECTABLE WARNING ACT (DWA) AS AMENDED BY THE DEPARTMENT OF TRANSPORTATION AND FEDERAL HIGHWAY ADMINISTRATION.
  3. THE DRIVEWAY SHALL BE CONFORMANT WITH THE REQUIREMENTS OF THE DETECTABLE WARNING ACT (DWA) AS AMENDED BY THE DEPARTMENT OF TRANSPORTATION AND FEDERAL HIGHWAY ADMINISTRATION.
  4. THE DRIVEWAY SHALL BE CONFORMANT WITH THE REQUIREMENTS OF THE DETECTABLE WARNING ACT (DWA) AS AMENDED BY THE DEPARTMENT OF TRANSPORTATION AND FEDERAL HIGHWAY ADMINISTRATION.
  5. THE DRIVEWAY SHALL BE CONFORMANT WITH THE REQUIREMENTS OF THE DETECTABLE WARNING ACT (DWA) AS AMENDED BY THE DEPARTMENT OF TRANSPORTATION AND FEDERAL HIGHWAY ADMINISTRATION.
  6. THE DRIVEWAY SHALL BE CONFORMANT WITH THE REQUIREMENTS OF THE DETECTABLE WARNING ACT (DWA) AS AMENDED BY THE DEPARTMENT OF TRANSPORTATION AND FEDERAL HIGHWAY ADMINISTRATION.

SECTION A-A DRIVEWAY SECTION

SECTION A-A DRIVEWAY SECTION

DRIVEWAY ENTRANCE

PROJECT NO.	
DATE	
SCALE	
DRAWN BY	
CHECKED BY	

**MISCELLANEOUS DETAILS FOR**  
 MILLER PLACE ROAD  
 TRAPIC, CALIFORNIA 94134  
 TOWN OF BROOKHAVEN

**WMP NELSON & POPE ENGINEERS & SURVEYORS**  
 2200 22ND AVENUE  
 SUITE 200  
 FORT COCKERMAN, CA 94505  
 WWW.NELSONPOPE.COM

CONTRACT NO.		DATE	
PROJECT NO.		SCALE	
DRAWN BY		CHECKED BY	
DATE		SCALE	

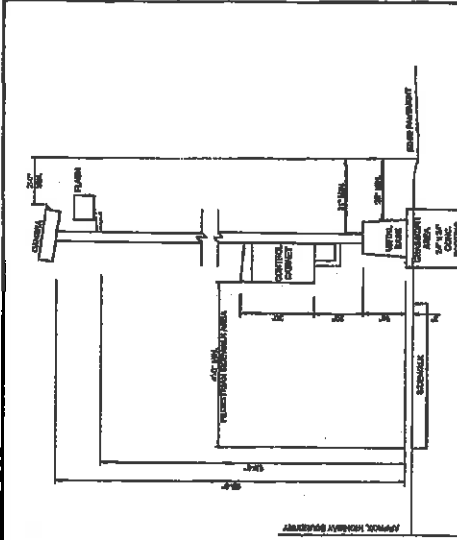

CAMERA POLE IN UTILITY STRIP W/ EDGE OF PAVEMENT

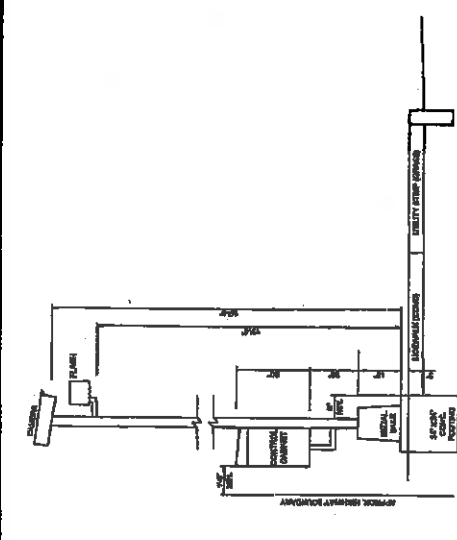

CAMERA POLE AT BACK OF SIDEWALK W/ CURB

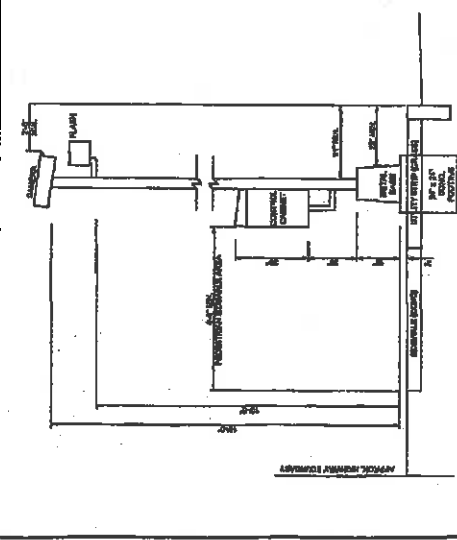

CAMERA POLE IN UTILITY STRIP W/ CURB

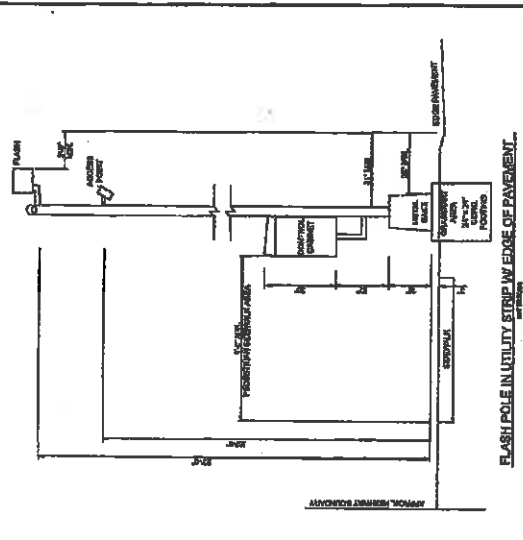

FLASH POLE IN UTILITY STRIP W/ EDGE OF PAVEMENT

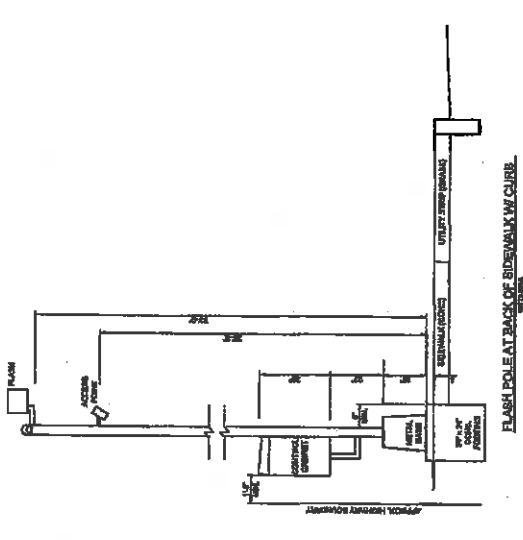

FLASH POLE AT BACK OF SIDEWALK W/ CURB

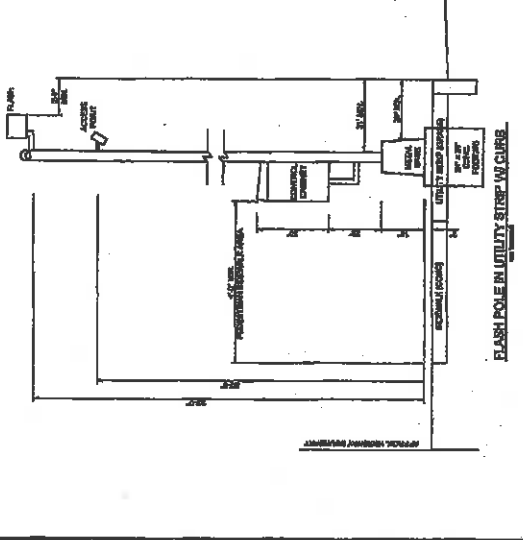

FLASH POLE IN UTILITY STRIP W/ CURB

				PROJECT NO. 008 DRAWING NO. MD-3 DATE: 10/11/02
NELSON & POPE ENGINEERS & SURVEYORS 1000 W. BROADWAY (813) 427-9885 FAX (813) 427-5920 WWW.NELSONPOPE.COM		MISCELLANEOUS DETAILS FOR MILLER AVENUE ROAD AT WYOMING AVE. TRAFFIC SIGNAL No. 51.5 TOWN OF BROOKHAVEN		
SHEET NO. 1 TOTAL SHEETS 1	DATE: 10/11/02	SCALE: AS SHOWN	DRAWN BY: J. POPE	CHECKED BY: J. POPE

**MAINTENANCE AND PROTECTION OF TRAFFIC NOTES**

- 1. The purpose of these notes is to provide a standard set of notes to be used by all maintenance workers on the job. The notes should be written in a clear, concise, and professional manner. The notes should be written in the first person and should be written in a professional manner.
- 2. The notes should be written in a clear, concise, and professional manner. The notes should be written in the first person and should be written in a professional manner.
- 3. The notes should be written in a clear, concise, and professional manner. The notes should be written in the first person and should be written in a professional manner.
- 4. The notes should be written in a clear, concise, and professional manner. The notes should be written in the first person and should be written in a professional manner.
- 5. The notes should be written in a clear, concise, and professional manner. The notes should be written in the first person and should be written in a professional manner.
- 6. The notes should be written in a clear, concise, and professional manner. The notes should be written in the first person and should be written in a professional manner.
- 7. The notes should be written in a clear, concise, and professional manner. The notes should be written in the first person and should be written in a professional manner.
- 8. The notes should be written in a clear, concise, and professional manner. The notes should be written in the first person and should be written in a professional manner.
- 9. The notes should be written in a clear, concise, and professional manner. The notes should be written in the first person and should be written in a professional manner.
- 10. The notes should be written in a clear, concise, and professional manner. The notes should be written in the first person and should be written in a professional manner.

SYMBOL	DESCRIPTION
1	WORK AREA
2	TRUCK
3	CONSTRUCTION
4	TRAFFIC
5	STOP
6	YIELD
7	NO LEFT TURN
8	NO RIGHT TURN
9	NO U-TURN
10	NO THROUGH TRAFFIC
11	NO THROUGH TRAFFIC
12	NO THROUGH TRAFFIC
13	NO THROUGH TRAFFIC
14	NO THROUGH TRAFFIC
15	NO THROUGH TRAFFIC
16	NO THROUGH TRAFFIC
17	NO THROUGH TRAFFIC
18	NO THROUGH TRAFFIC
19	NO THROUGH TRAFFIC
20	NO THROUGH TRAFFIC

SYMBOL	DESCRIPTION
21	WORK AREA
22	TRUCK
23	CONSTRUCTION
24	TRAFFIC
25	STOP
26	YIELD
27	NO LEFT TURN
28	NO RIGHT TURN
29	NO U-TURN
30	NO THROUGH TRAFFIC
31	NO THROUGH TRAFFIC
32	NO THROUGH TRAFFIC
33	NO THROUGH TRAFFIC
34	NO THROUGH TRAFFIC
35	NO THROUGH TRAFFIC
36	NO THROUGH TRAFFIC
37	NO THROUGH TRAFFIC
38	NO THROUGH TRAFFIC
39	NO THROUGH TRAFFIC
40	NO THROUGH TRAFFIC

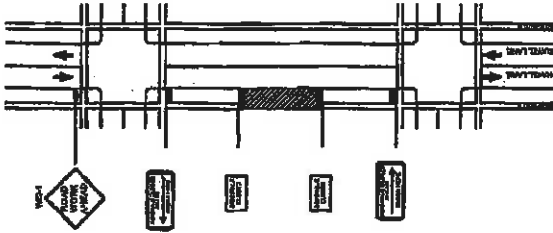

SIDEWALK CLOSURE DETOUR, ITEM 616.01

- 1. THE CONTRACTOR SHALL BE RESPONSIBLE FOR OBTAINING ALL NECESSARY PERMITS AND APPROVALS FROM THE LOCAL, STATE, AND FEDERAL AUTHORITIES.
- 2. THE CONTRACTOR SHALL BE RESPONSIBLE FOR OBTAINING ALL NECESSARY PERMITS AND APPROVALS FROM THE LOCAL, STATE, AND FEDERAL AUTHORITIES.
- 3. THE CONTRACTOR SHALL BE RESPONSIBLE FOR OBTAINING ALL NECESSARY PERMITS AND APPROVALS FROM THE LOCAL, STATE, AND FEDERAL AUTHORITIES.
- 4. THE CONTRACTOR SHALL BE RESPONSIBLE FOR OBTAINING ALL NECESSARY PERMITS AND APPROVALS FROM THE LOCAL, STATE, AND FEDERAL AUTHORITIES.
- 5. THE CONTRACTOR SHALL BE RESPONSIBLE FOR OBTAINING ALL NECESSARY PERMITS AND APPROVALS FROM THE LOCAL, STATE, AND FEDERAL AUTHORITIES.
- 6. THE CONTRACTOR SHALL BE RESPONSIBLE FOR OBTAINING ALL NECESSARY PERMITS AND APPROVALS FROM THE LOCAL, STATE, AND FEDERAL AUTHORITIES.

PROJECT NO.	003
DRAWING NO.	MPT-1
DATE	
SCALE	
PROJECT LOCATION	MILLERS FALLS ROAD AT INTERSECTION OF TOWN OF BROOKHAVEN
PROJECT DESCRIPTION	TRAFFIC SIGNAL NO. 315
PROJECT OWNER	
PROJECT ENGINEER	
PROJECT CONTRACTOR	
PROJECT SUBCONTRACTOR	
PROJECT ASSISTANT	



**NELSON & POPE**  
 ENGINEERS & SURVEYORS  
 1000 WEST 10TH AVENUE  
 DENVER, CO 80202  
 (303) 427-6665 FAX (303) 427-6529  
 WWW.NELSONPOPE.COM

DATE	10/15/03
PROJECT NO.	003
DRAWING NO.	MPT-1
DATE	
SCALE	
PROJECT LOCATION	MILLERS FALLS ROAD AT INTERSECTION OF TOWN OF BROOKHAVEN
PROJECT DESCRIPTION	TRAFFIC SIGNAL NO. 315
PROJECT OWNER	
PROJECT ENGINEER	
PROJECT CONTRACTOR	
PROJECT SUBCONTRACTOR	
PROJECT ASSISTANT	

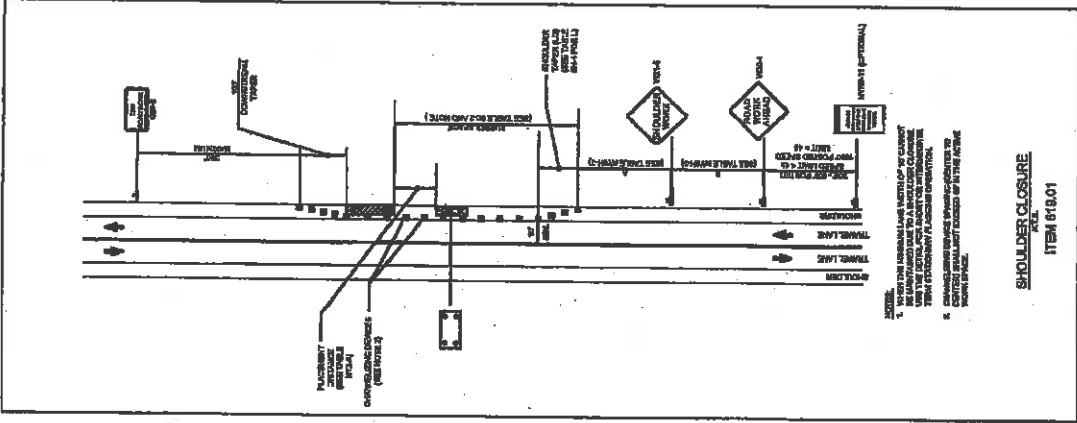

**SHOULDER CLOSURE**  
ITEM 619.01

- 1. ALL TRAFFIC MUST BE MAINTAINED IN THE TRAVEL LANES.
- 2. CONSTRUCTION BARRIERS SHOULD BE PLACED AT THE END OF THE SHOULDER CLOSURE.
- 3. CONSTRUCTION BARRIERS SHOULD BE PLACED AT THE START OF THE SHOULDER CLOSURE.
- 4. WORKERS SHOULD BE PLACED AT THE END OF THE SHOULDER CLOSURE.
- 5. WORKERS SHOULD BE PLACED AT THE START OF THE SHOULDER CLOSURE.

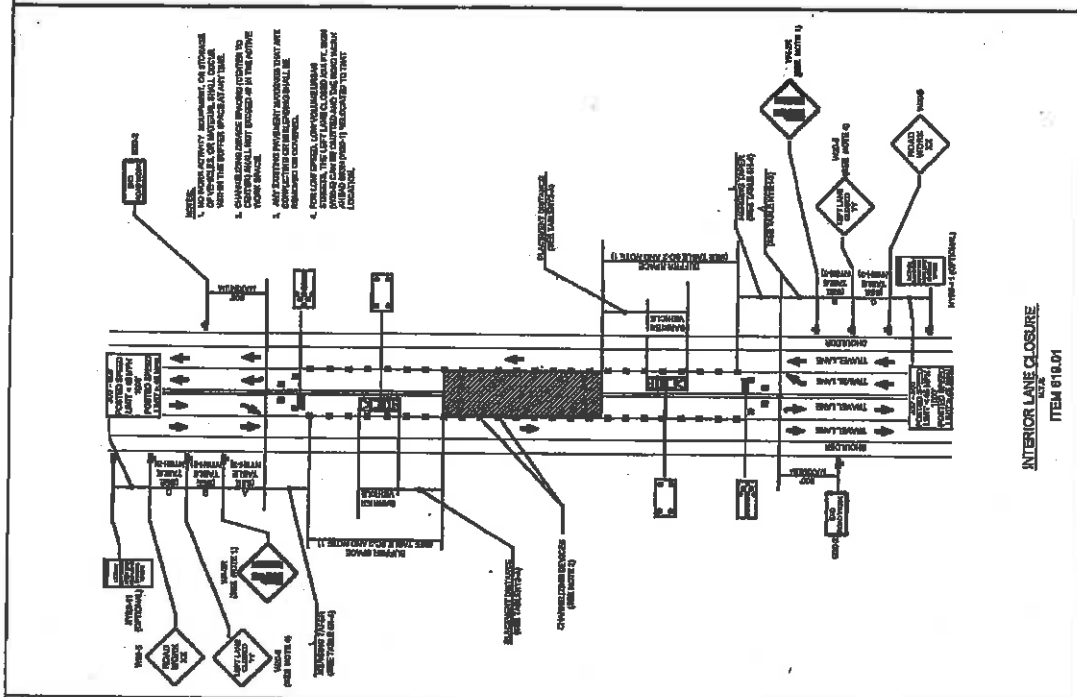

**INTERIOR LANE CLOSURE**  
ITEM 619.01

- 1. ALL TRAFFIC MUST BE MAINTAINED IN THE TRAVEL LANES.
- 2. CONSTRUCTION BARRIERS SHOULD BE PLACED AT THE END OF THE INTERIOR LANE CLOSURE.
- 3. CONSTRUCTION BARRIERS SHOULD BE PLACED AT THE START OF THE INTERIOR LANE CLOSURE.
- 4. WORKERS SHOULD BE PLACED AT THE END OF THE INTERIOR LANE CLOSURE.
- 5. WORKERS SHOULD BE PLACED AT THE START OF THE INTERIOR LANE CLOSURE.

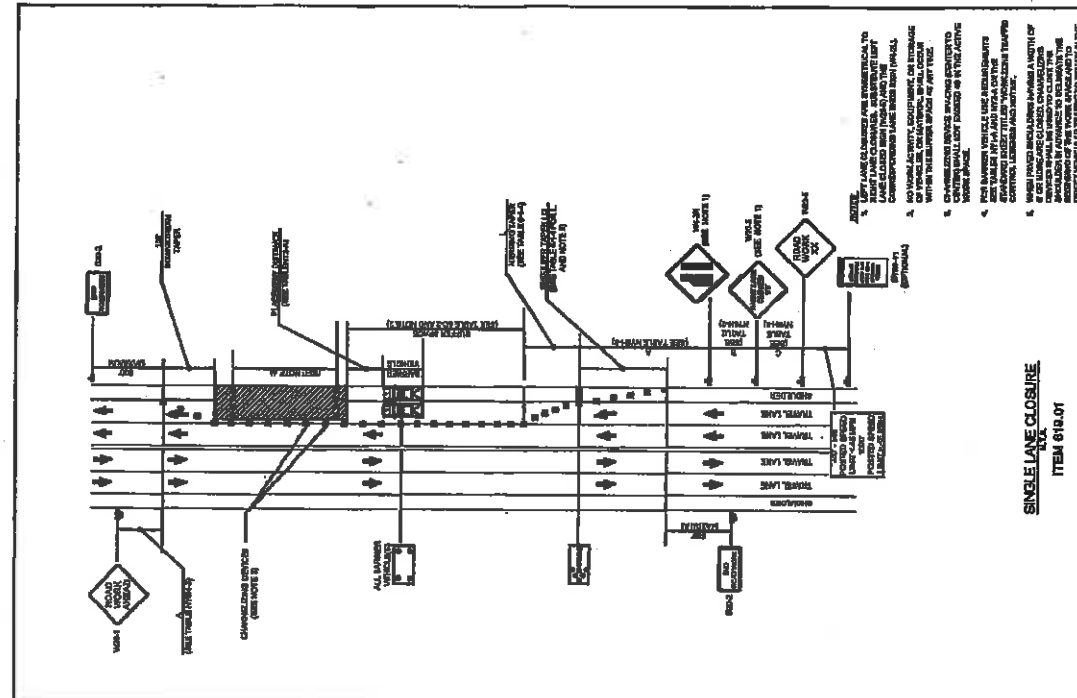

**SINGLE LANE CLOSURE**  
ITEM 619.01

- 1. ALL TRAFFIC MUST BE MAINTAINED IN THE TRAVEL LANES.
- 2. CONSTRUCTION BARRIERS SHOULD BE PLACED AT THE END OF THE SINGLE LANE CLOSURE.
- 3. CONSTRUCTION BARRIERS SHOULD BE PLACED AT THE START OF THE SINGLE LANE CLOSURE.
- 4. WORKERS SHOULD BE PLACED AT THE END OF THE SINGLE LANE CLOSURE.
- 5. WORKERS SHOULD BE PLACED AT THE START OF THE SINGLE LANE CLOSURE.

PROJECT NO. 003		DATE: 05/01/01	
PROJECT NAME: MAINTENANCE AND PROTECTION OF TRAFFIC		PROJECT LOCATION: MILLER PLACE ROAD AT NY 6 AREA	
PROJECT NUMBER: MPT-2		TRAFFIC SIGNAL NO. 3115	
PROJECT DESCRIPTION: TOWNSHIP OF BROOKHAVEN		PROJECT STATUS: IN PROGRESS	
CONTRACTOR:	DESIGNER:	DATE:	SCALE:
			
			
<b>NELSON &amp; POPE</b> ENGINEERS • SURVEYORS 50 WEST WINDHAM AVENUE, 10TH FLOOR ALBANY, NY 12206-4209 WWW.NELSON-POPE.COM			

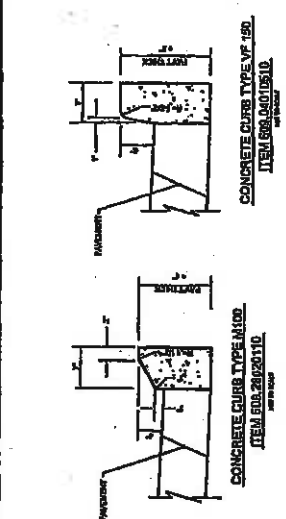

**CONCRETE CURB TYPE V-19D**  
ITEM 260.040(19D)

**CONCRETE CURB TYPE M-10**  
ITEM 260.040(10)

**CURB NOTES:**  
1. CURB SHALL BE CONCRETE WITH 4% AIR ENTRAINMENT.  
2. CURB SHALL BE CAST ON A 2 INCH SAND BED ON A 4 INCH GRANULAR FILL ON A 4 INCH GRANULAR SUBGRADE.

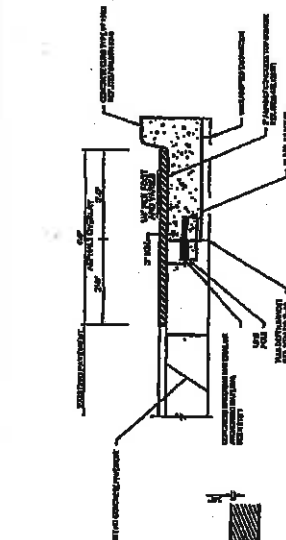

**CONCRETE CURB AND GUTTER TYPE VZ-1900**  
ITEM 260.050(10)

**NOTES:**  
1. CURB SHALL BE CONCRETE WITH 4% AIR ENTRAINMENT.  
2. CURB SHALL BE CAST ON A 2 INCH SAND BED ON A 4 INCH GRANULAR FILL ON A 4 INCH GRANULAR SUBGRADE.

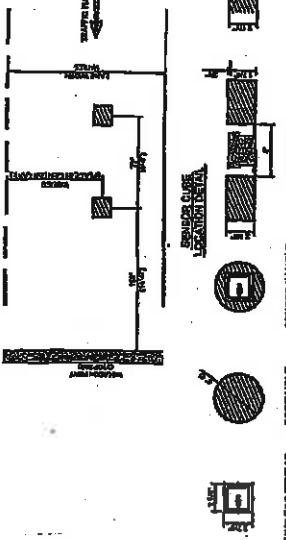

**WIRELESS SENSOR INSTALLATION DETAILS**

**NOTES:**  
1. CURB SHALL BE CONCRETE WITH 4% AIR ENTRAINMENT.  
2. CURB SHALL BE CAST ON A 2 INCH SAND BED ON A 4 INCH GRANULAR FILL ON A 4 INCH GRANULAR SUBGRADE.

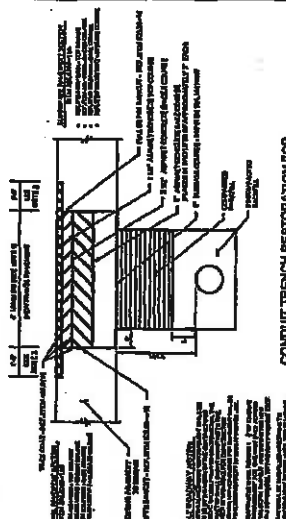

**CONDUIT TRENCH RESTORATION FOR ASPHALT ROADWAYS**  
ITEM 260.035(10)

**NOTES:**  
1. TRENCH SHALL BE 6 INCH DEEP AND 12 INCH WIDE.  
2. TRENCH SHALL BE FILLED WITH 1/2 INCH SAND BED ON A 4 INCH GRANULAR FILL ON A 4 INCH GRANULAR SUBGRADE.

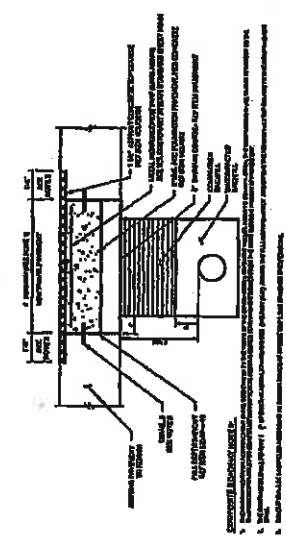

**CONDUIT TRENCH RESTORATION FOR COMPOSITE ROADWAYS**  
ITEM 260.037(10)

**NOTES:**  
1. TRENCH SHALL BE 6 INCH DEEP AND 12 INCH WIDE.  
2. TRENCH SHALL BE FILLED WITH 1/2 INCH SAND BED ON A 4 INCH GRANULAR FILL ON A 4 INCH GRANULAR SUBGRADE.

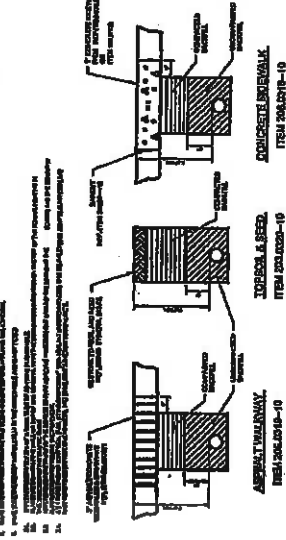

**ASPHALT DRIVEWAY AND CONCRETE SIDEWALK RESTORATION**  
ITEM 260.020(10)

**NOTES:**  
1. DRIVEWAY SHALL BE 12 INCH WIDE AND 6 INCH DEEP.  
2. SIDEWALK SHALL BE 12 INCH WIDE AND 6 INCH HIGH.

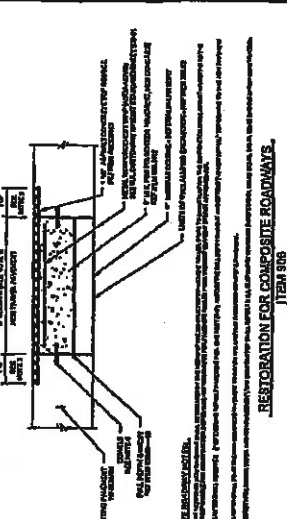

**RESTORATION FOR COMPOSITE ROADWAYS**  
ITEM 260

**NOTES:**  
1. ROADWAY SHALL BE 12 INCH WIDE AND 6 INCH HIGH.  
2. ROADWAY SHALL BE SUPPORTED BY A 2 INCH SAND BED ON A 4 INCH GRANULAR FILL ON A 4 INCH GRANULAR SUBGRADE.

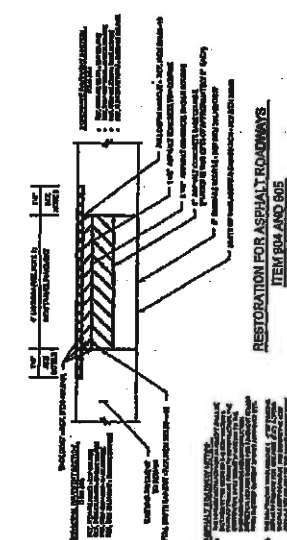

**RESTORATION FOR ASPHALT ROADWAYS**  
ITEM 260 AND 265

**NOTES:**  
1. ROADWAY SHALL BE 12 INCH WIDE AND 6 INCH HIGH.  
2. ROADWAY SHALL BE SUPPORTED BY A 2 INCH SAND BED ON A 4 INCH GRANULAR FILL ON A 4 INCH GRANULAR SUBGRADE.

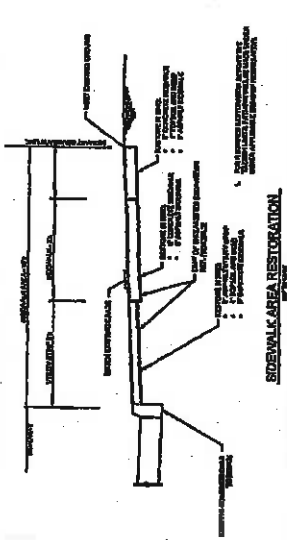

**SIDEWALK AREA RESTORATION**  
ITEM 260

**NOTES:**  
1. SIDEWALK SHALL BE 12 INCH WIDE AND 6 INCH HIGH.  
2. SIDEWALK SHALL BE SUPPORTED BY A 2 INCH SAND BED ON A 4 INCH GRANULAR FILL ON A 4 INCH GRANULAR SUBGRADE.

<p><b>NELSON &amp; POPE</b> ENGINEERS • SURVEYORS 2200 MILLER PLACE ROAD ATLANTA, GA 30329 WWW.NELSON-POPE.COM</p>		<p><b>MISCELLANEOUS DETAILS</b> MILLER PLACE ROAD ATLANTA, GA TRAFFIC SIGNAL No. 51.5 TOWN OF BUCKWATER</p>	
<p>DATE: _____</p> <p>PROJECT: _____</p> <p>SCALE: _____</p> <p>DESIGNER: _____</p> <p>CHECKED: _____</p> <p>APPROVED: _____</p>	<p>DATE: _____</p> <p>PROJECT: _____</p> <p>SCALE: _____</p> <p>DESIGNER: _____</p> <p>CHECKED: _____</p> <p>APPROVED: _____</p>	<p>DATE: _____</p> <p>PROJECT: _____</p> <p>SCALE: _____</p> <p>DESIGNER: _____</p> <p>CHECKED: _____</p> <p>APPROVED: _____</p>	<p>DATE: _____</p> <p>PROJECT: _____</p> <p>SCALE: _____</p> <p>DESIGNER: _____</p> <p>CHECKED: _____</p> <p>APPROVED: _____</p>