



PROJECT LOCATION

VICINITY MAP

LEGEND	
	UNDERGROUND CONDUIT (TRENCH)
	DIRECTIONAL BORE
	REAR MONITOR CAMERA ON ATS POLE
	EXISTING WIRELESS VEHICLE DETECTION SENSORS
	17' x 30' PULL/JUNCTION BOX
	PHOTO ENFORCEMENT SIGN
	ATS METER POLE
	ATS METER PEDESTAL
	EXISTING UNDERGROUND CONDUIT
	EXISTING STREET LIGHT
	EXISTING FIRE HYDRANT
	EXISTING SIGNAL HEAD
	EXISTING MANHOLE
	EXISTING PULL/JUNCTION BOX
	EXISTING LOOPS
	EXISTING TRAFFIC CONTROLLER
	EXISTING METER PEDESTAL
	EXISTING WOOD POLE
	EXISTING CONCRETE POLE

- NOTES
- ALL WORK AND MATERIAL SHALL BE IN ACCORDANCE WITH SECTION 555, FDOT STANDARD SPECIFICATION FOR DIRECTIONAL BORE.
  - MAINTENANCE OF TRAFFIC SHALL BE PER THE LATEST EDITION OF FDOT STANDARDS INDEX 600 AS APPLICABLE.
  - WORK THAT WILL AFFECT THE OPERATION OF THE TRAFFIC SIGNAL SHALL NOT BE DONE BETWEEN THE HOURS OF 7AM-9AM OR 4PM-6PM. AN OFF DUTY LAW ENFORCEMENT OFFICER MUST BE PRESENT WHEN TRAFFIC SIGNAL IS NOT IN FULL OPERATION.
  - THE CONTRACTOR SHALL CONTACT THE CITY OF TAMPA TRAFFIC ENGINEERING (813-274-8333) AT LEAST 48 HOURS IN ADVANCE TO COORDINATE ANY WORK AT THE SIGNAL.
  - UTILITY LOCATIONS ARE TO BE FIELD VERIFIED BY CONTRACTOR PRIOR TO BEGINING CONSTRUCTION.
  - NEW CONDUIT IS TO BE INSTALLED AT A MINIMUM DEPTH OF 30" AND A MINIMUM DEPTH OF 36" WHEN TRAVELING UNDER PAVEMENT. SEE FDOT INDEX NO. 17721.
  - CONTRACTOR SHALL CALL 811 FOR UTILITY LOCATES PRIOR TO CONSTRUCTION.
  - POSTED SPEED LIMIT: US 41 / S. 50TH ST / TAMIAAMI TR - 40 MPH & SR 60 / ADAMO DR - 50 MPH.
  - ALL SIGN INSTALLATIONS SHALL BE IN ACCORDANCE WITH FDOT STANDARD INDEX 11860 AND 17302.
  - EARTH TO GROUND RESISTANCE NEEDS TO BE 25 OHMS OR ADDITIONAL GROUND RODS MAYBE NEEDED.

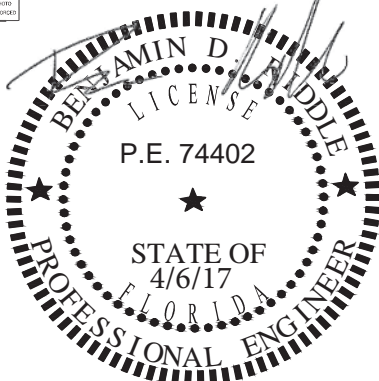
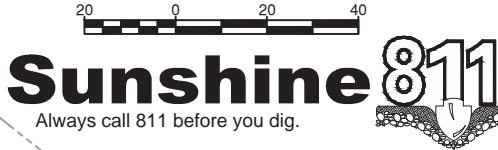
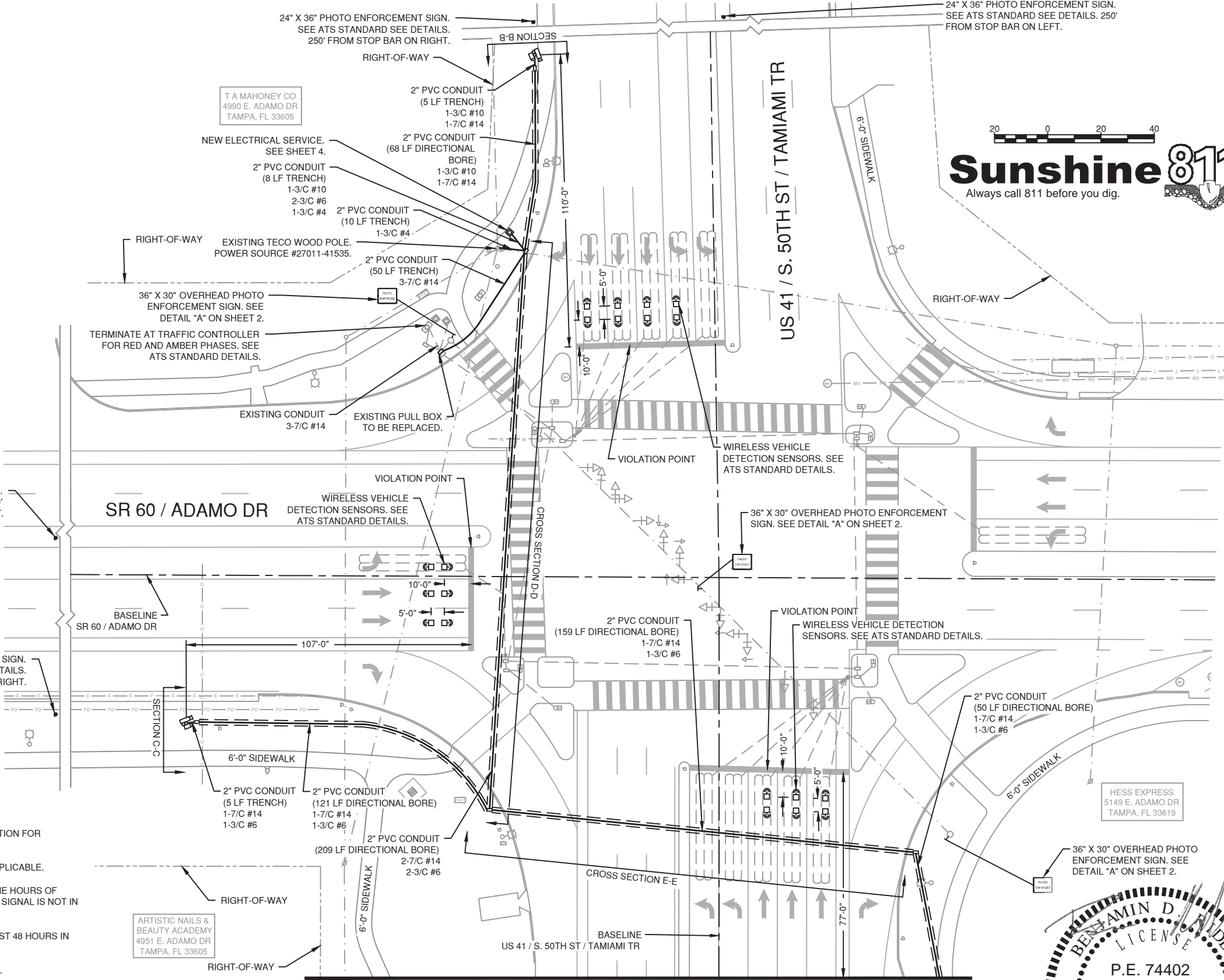



American  
Traffic Solutions

RED LIGHT PHOTO ENFORCEMENT PROGRAM

1150 N. ALMA SCHOOL RD  
MESA, AZ 85201 USA  
TEL: (480)443-7000 FAX: (480)607-0901  
WWW.ATSOL.COM

ENGINEER OF RECORD:  
BENJAMIN D. RIDDLE, P.E.  
REG. # 74402

INTERSECTION PLAN  
SR 60 / ADAMO DR AT  
US 41 / S 50TH ST / TAMIAAMI TR  
TAMPA, FL

NO.	BY	DATE	REVISION	NO.	BY	DATE	REVISION

1ST SUBMITTAL  
DESIGNED BY: VP  
DATE: 03-08-17  
APPROVED BY:  
APPROVAL DATE:

JOB NUMBER  
1344  
SITE ID(S)  
TP01, TP31, TP32

SHEET  
NUMBER  
1  
OF 4 SHEETS

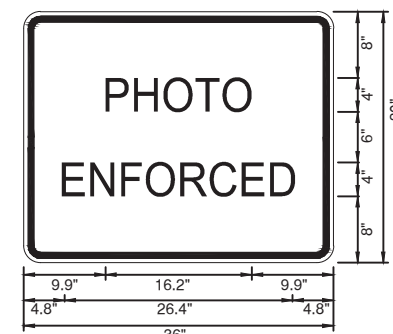
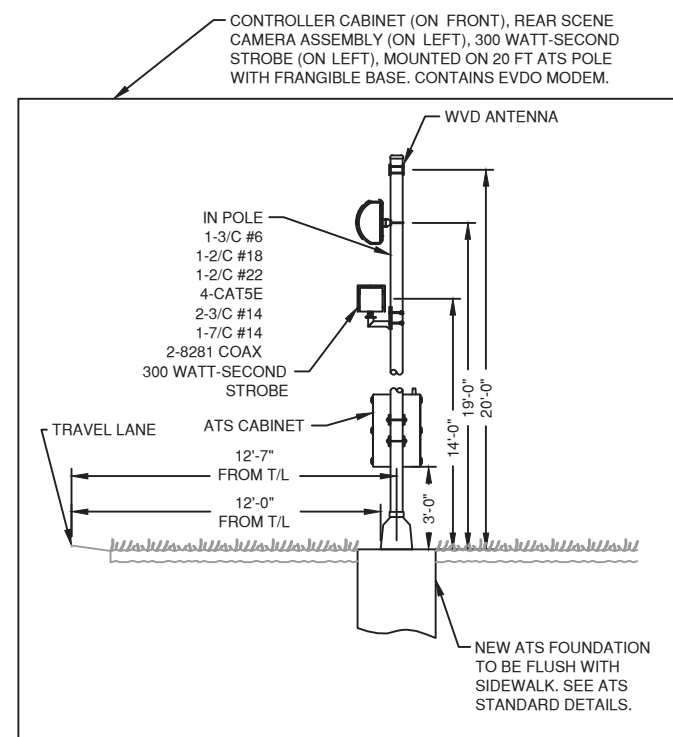
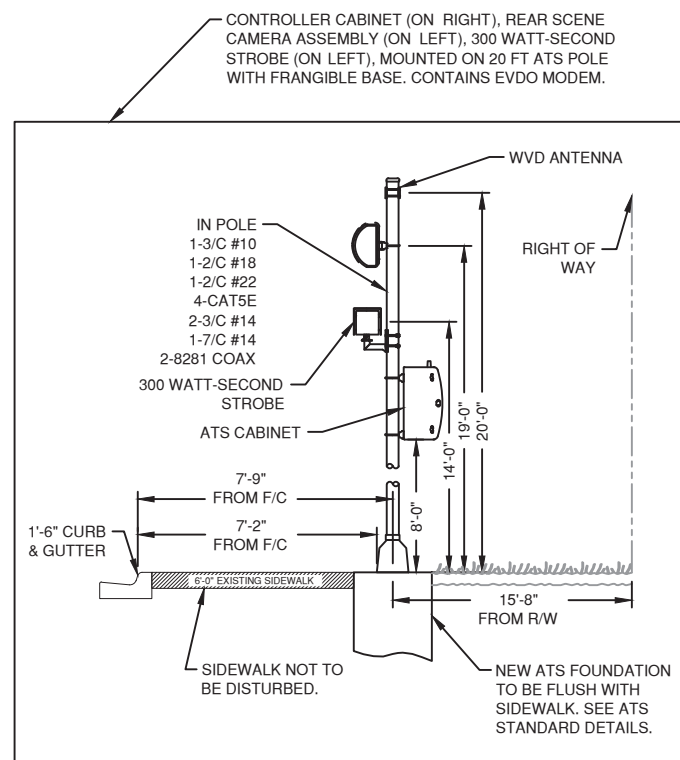
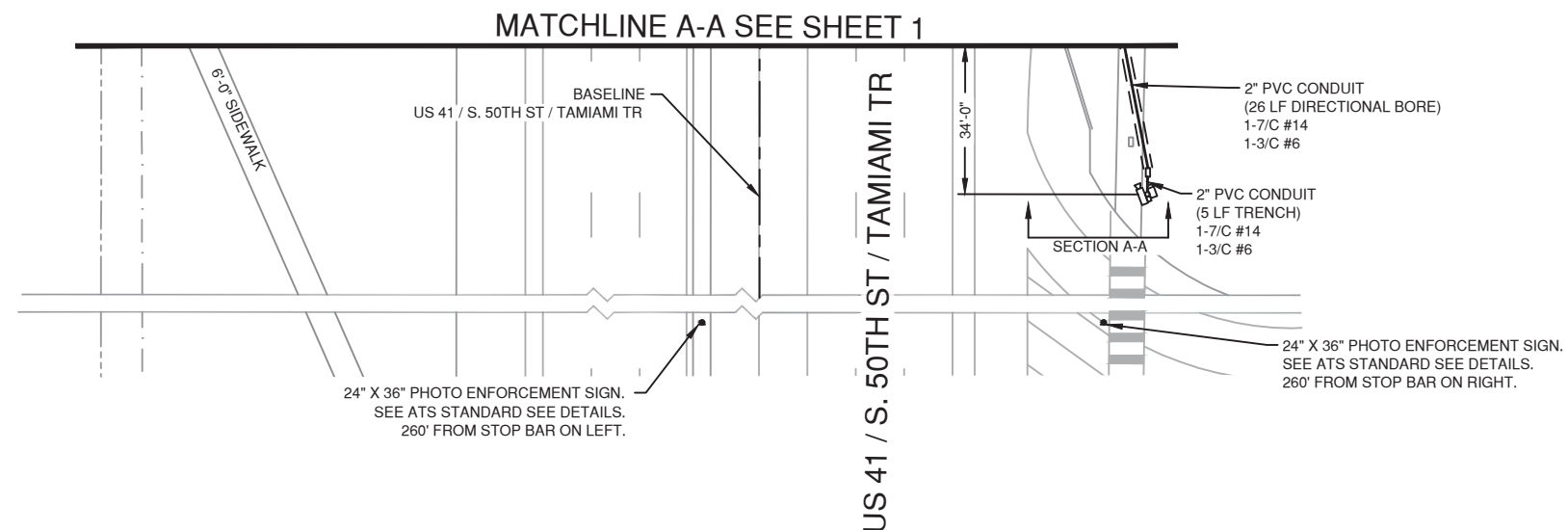
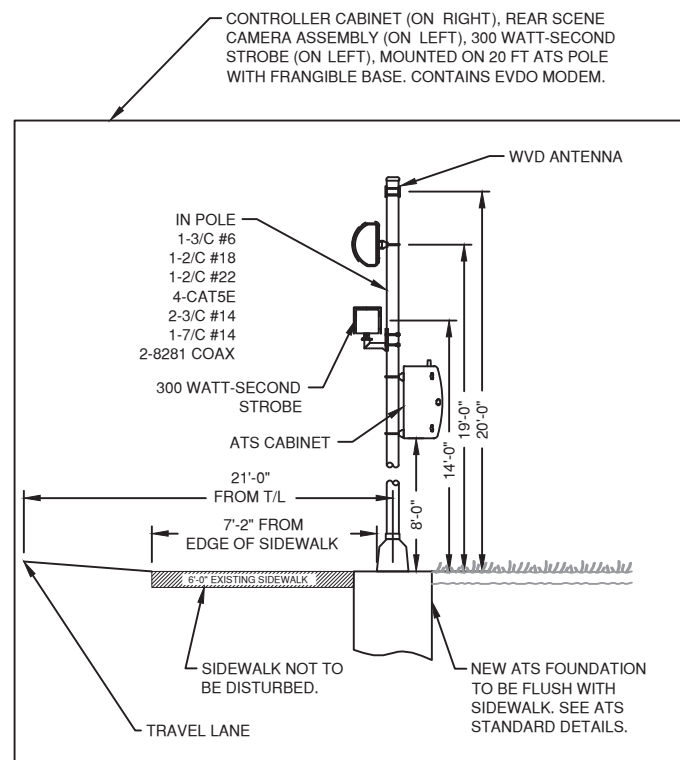

2.3" RADIUS, 0.6" BORDER, 0.9" INDENT, BLACK ON WHITE;  
"PHOTO" D 2K; "ENFORCED" D 2K;

TABLE OF LETTER AND OBJECT LEFTS.

P	H	O	T	O			
9.9"	13.3"	16.9"	20.2"	23.2"			
E	N	F	O	R	C	E	D
4.8"	8.0"	11.7"	14.7"	18.4"	21.7"	25.3"	28.5"

DETAIL "A"  
PHOTO ENFORCED SIGN

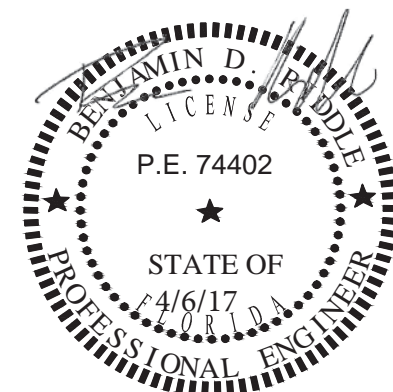

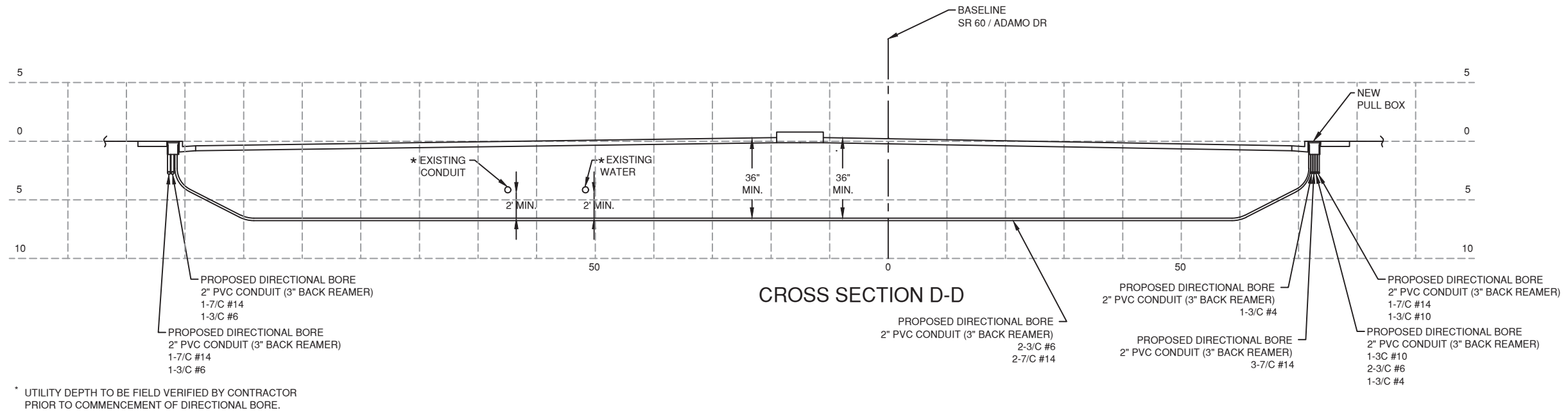

GENERAL NOTES:

1. ALL WORK AND MATERIAL SHALL BE IN ACCORDANCE WITH SECTION 555, FDOT STANDARD SPECIFICATION FOR DIRECTIONAL BORE.
2. CONTRACTOR SHALL NOTIFY THE UTILITY OWNER AT LEAST 48 HOURS IN ADVANCE OF CONSTRUCTION.
3. CONTRACTOR SHALL SOFT DIG TO VERTICALLY AND HORIZONTALLY LOCATE ALL UTILITIES PRIOR TO COMMENCEMENT OF THE DIRECTIONAL BORE.
4. CONTRACTOR SHALL RESTORE ALL AFFECTED AND DISTURBED AREAS IN ACCORDANCE WITH FDOT STANDARDS.
5. MAINTENANCE OF TRAFFIC SHALL BE IN ACCORDANCE WITH THE FDOT STANDARD INDEX 600.
6. ALL SIDEWALK CONSTRUCTION SHALL BE IN ACCORDANCE WITH FDOT STANDARD INDEX 304 AND STANDARD INDEX 310.
7. SCH. 80 PVC CONDUIT TO BE BORED UNDER ROADWAY MUST HAVE A MINIMUM COVER OF 36".

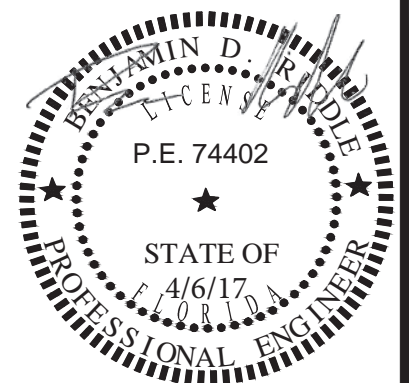
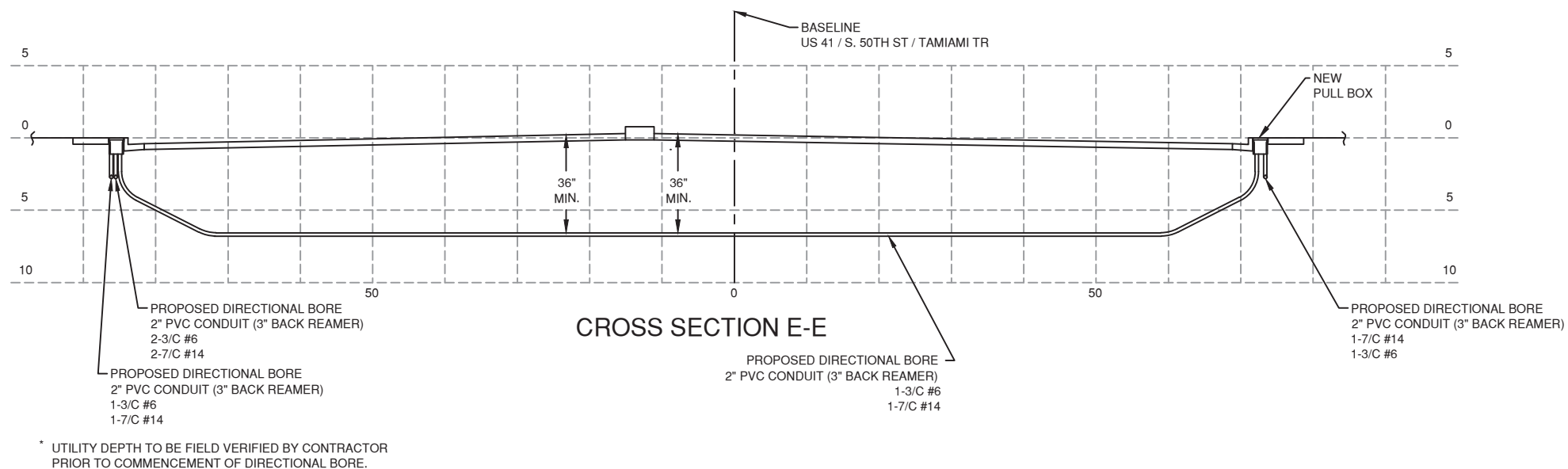

NO.	BY	DATE	REVISION	NO.	BY	DATE	REVISION

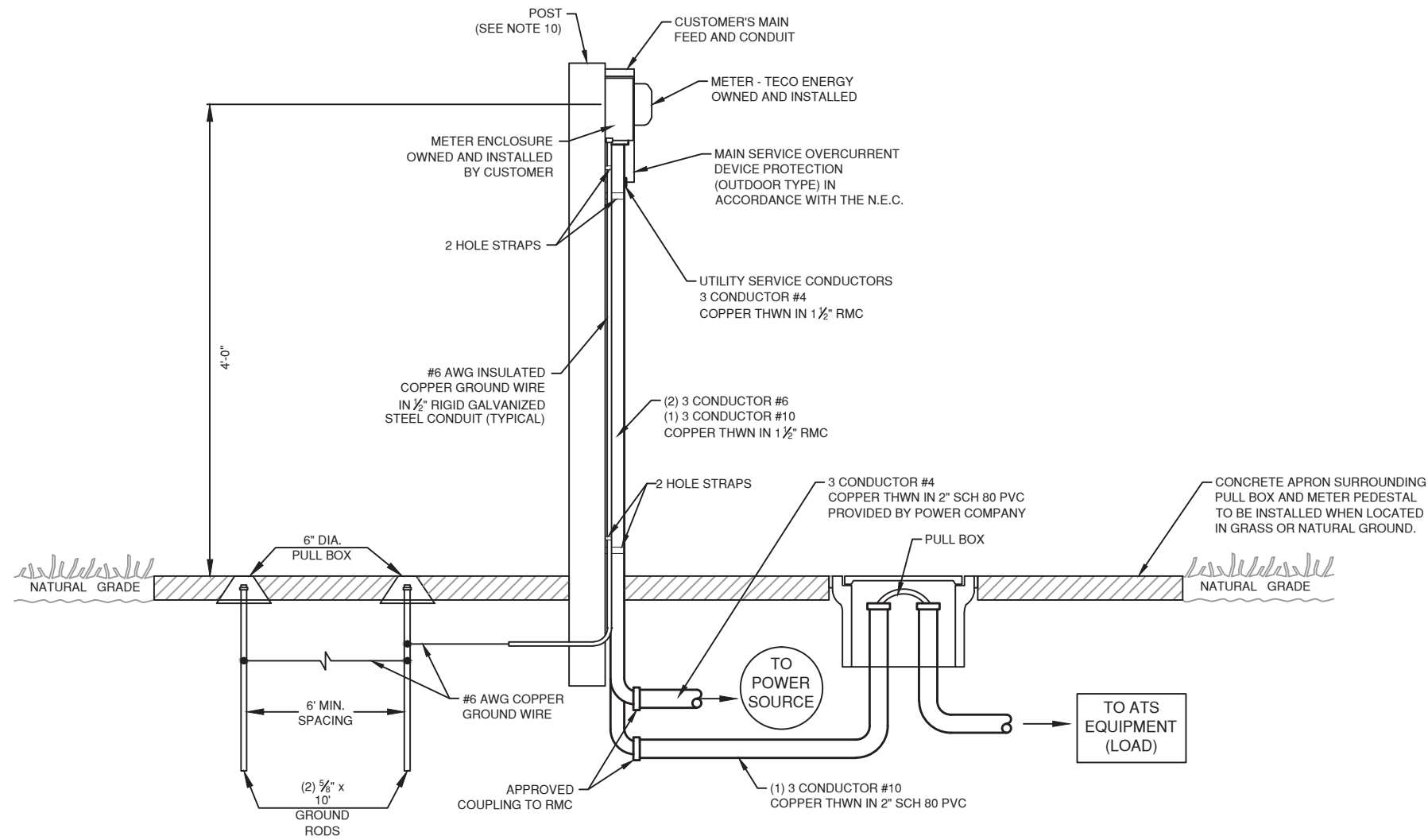

ATS PANEL

MANUFACTURE - SQUARE D OR EQUAL						12/24 CIRCUIT, 125 AMP RATING						SINGLE PHASE, 120/240 V					
22 KAIC						70A MAIN BREAKER						LOCATION - METER PEDESTAL					
LOAD	CONDUIT	WIRE	TRIP	1P/2P	VOLTS	DESCRIPTION	CKT	CKT	DESCRIPTION	VOLTS	1P/2P	TRIP	WIRE	CONDUIT	LOAD		
			30A	2P		SURGE ARRESTOR	1	2	RLC (ATS)	120	1P	30A	#6	2"	2135		
							3	4	SPACE								
						SPACE	5	6	RLC (ATS)	120	1P	30A	#6	2"	2135		
2135	2"	#10	30A	1P	120	RLC (ATS)	7	8	SPACE								
						SPACE	9	10	SPACE								
						SPACE	11	12	SPACE								
TOTAL LOAD: 2135 WATTS (PER RLC)										TOTAL AMPS: 30AMPS (PER RLC)							

- ELECTRICAL NOTES:
- ELECTRICAL DETAILS ARE FOR ILLUSTRATIVE PURPOSES ONLY. THE FOLLOWING NOTES, DETAILS, AND PANEL SCHEDULE ARE BASED ON INFORMATION PROVIDED BY THE ELECTRICAL CONTRACTOR DESCRIBING THEIR CONSTRUCTION METHODS AND MATERIALS.
  - REFER TO TECO ELECTRIC SERVICE STANDARDS.
  - THE LIGHTING ARRESTOR WILL BE MOUNTED ON THE MAIN/SERVICE DISCONNECT ENCLOSURE. LIGHTING ARRESTOR CONDUCTORS CANNOT BE "DOUBLED UP" IN THE SAME LUG OF THE MAIN BREAKER OCPD AND SHOULD HAVE ITS OWN PRESSURE LUGS OR CIRCUIT BREAKER TO TERMINATE CONDUCTORS.
  - SERVICE WIRING - 3 CONDUCTOR #4 COPPER THWN.
  - METER SOCKET - 125 AMP RATING, 120/240 NEMA 3R.
  - ELECTRICAL CONTRACTOR WILL USE A SQUARE D (OR EQUIVALENT) 125 AMP RATING, 2 POLE, SINGLE PHASE, 120/240 VOLT, WITH ONE 70AMP DUAL POLE MAIN BREAKER, ONE SINGLE POLE 30AMP CIRCUIT BREAKER, ONE DUAL POLE 30AMP, AND THWN (OR EQUIVALENT) POWER WIRE AS DESCRIBED IN PANEL SCHEDULE.
  - ALL UNDERGROUND SERVICE CONDUIT SHALL BE A MINIMUM OF 36" DEEP.
  - USE #6 AWG EQUIPMENT GROUNDING CONDUCTOR AS REQUIRED (TYPICAL TO BOND METAL POLE TO GROUND ROD).
  - (2) 5/8" X 10' GROUNDING ELECTRODE CONDUCTOR, #6 AWG SHALL BE USED.
  - POST TO BE CONSTRUCTED OF REINFORCED CONCRETE (5"x5") OR 4"x4" PRESSURE TREATED WOOD WITH 2" GALVANIZED STEEL PIPE WITH 2" CONCRETE ENCASEMENT BELOW GROUND LEVEL, OR EQUIVALENT. MINIMUM 3' BURIED BELOW GROUND LEVEL.
  - WIRING SHALL ADHERE TO MANUFACTURER RECOMMENDATIONS AND SHALL CONFORM TO THE NEC. INSULATION RATING FOR EACH SET OF CONDUCTORS SHALL MEET THE REQUIREMENTS FOR THE HIGHEST VOLTAGE PRESENT IN A COMMON SHARED CONDUIT, RACEWAY, OR ENCLOSURE.
  - ALL PULL BOX LIDS SHALL BE POLYMER CONCRETE.
  - CONCRETE APRON TO BE INSTALLED IN ACCORDANCE WITH FDOT STANDARD INDEX 17504.

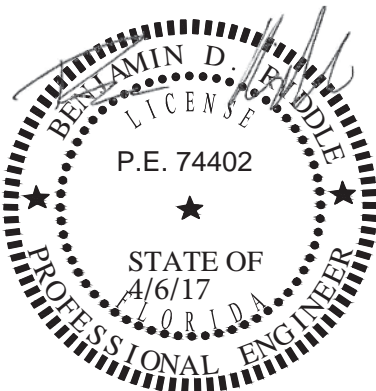

NO.	BY	DATE	REVISION	NO.	BY	DATE	REVISION